

ORDINANCE NO. 781

AN ORDINANCE AMENDING SECTION 4.05
OF ORDINANCE NO. 398 OF THE CITY
OF CHULA VISTA.

THE CITY COUNCIL OF THE CITY OF CHULA VISTA DOES
ORDAIN AS FOLLOWS:

Section 1: Section 4.05 of Ordinance No. 398 is
hereby amended to read as follows:

SECTION 4.05: ZONING MAPS. The zones set forth
in Sections 4.00, 4.10 and 4.11 of this Ordinance, and
the boundaries of all of said zones, are shown upon those
maps attached hereto, being designated as the "Zoning Map",
"Zoning Map II", and each Zoning Map numbered consecutive-
ly thereafter, to and including Zoning Map No. 68,
except therefrom Zoning Map No. XXIX, and said maps and all
other notations, references and other information shown
thereon shall be as much a part of this ordinance as if
the matters and information set forth on said maps were
all fully described herein.

SECTION 2: The Chula Vista Building Line Map, reference to
which is hereby made and the same incorporated herein as though here set forth
in full, is hereby amended, modified, and changed to show a building set-back
of five feet on the Southerly side of "L" Street, West 165 feet from the
Westerly line of Third Avenue and a building set-back line of five feet on
the Westerly side of Third Avenue South 35 feet from the Southerly side of
"L" Street.

RESOLUTION NO. 1175 PASSED BY THE CITY COUNCIL OF THE CITY OF
CHULA VISTA, CALIFORNIA, ON THE 9th day of January
1962 by the following vote, to-wit:

AYES: Smith, McMains, McAllister, Menzel, DeGraaf

NAYS: CORRECTION None

ABSENT: CORRECTION None

Keith W. Menzel
Mayor of the City of Chula Vista

ATTEST: Kenneth Campbell
City Clerk

STATE OF CALIFORNIA)
COUNTY OF SAN DIEGO) ss:
CITY OF CHULA VISTA)

I, KENNETH C. CAMPBELL, City Clerk of the City of Chula Vista,
California, DO HEREBY CERTIFY that the above and foregoing is a
true, correct and correct copy of _____
and that the same has been recorded in _____

DATED _____

CITY CLERK

00781

- 1157. Fence Northwest along the Western line of Section 2, T. 20 N. R. 20 E. (approximate 47°) line parallel to and 200' from boundary from the Southern line of Line 1000.
- 1158. Fence Northwest along the Eastern prolongation of said parallel line to an intersection with a line parallel to and 250' from boundary from the Western line of Section 2, T. 20 N. R. 20 E.
- 1159. Fence Northwest along said parallel line to an intersection with the Eastern prolongation of the Northwest line of Line 1000.
- 1160. Fence Northwest along said parallel line to the point of beginning.

Map 111, 1937
 Rev. and March 12, 1947

ZONING MAP 68

CITY OF CHULA VISTA
CALIFORNIA

ADOPTED BY THE CITY OF CHULA VISTA
ORD NO 781 DATED 1-2-62

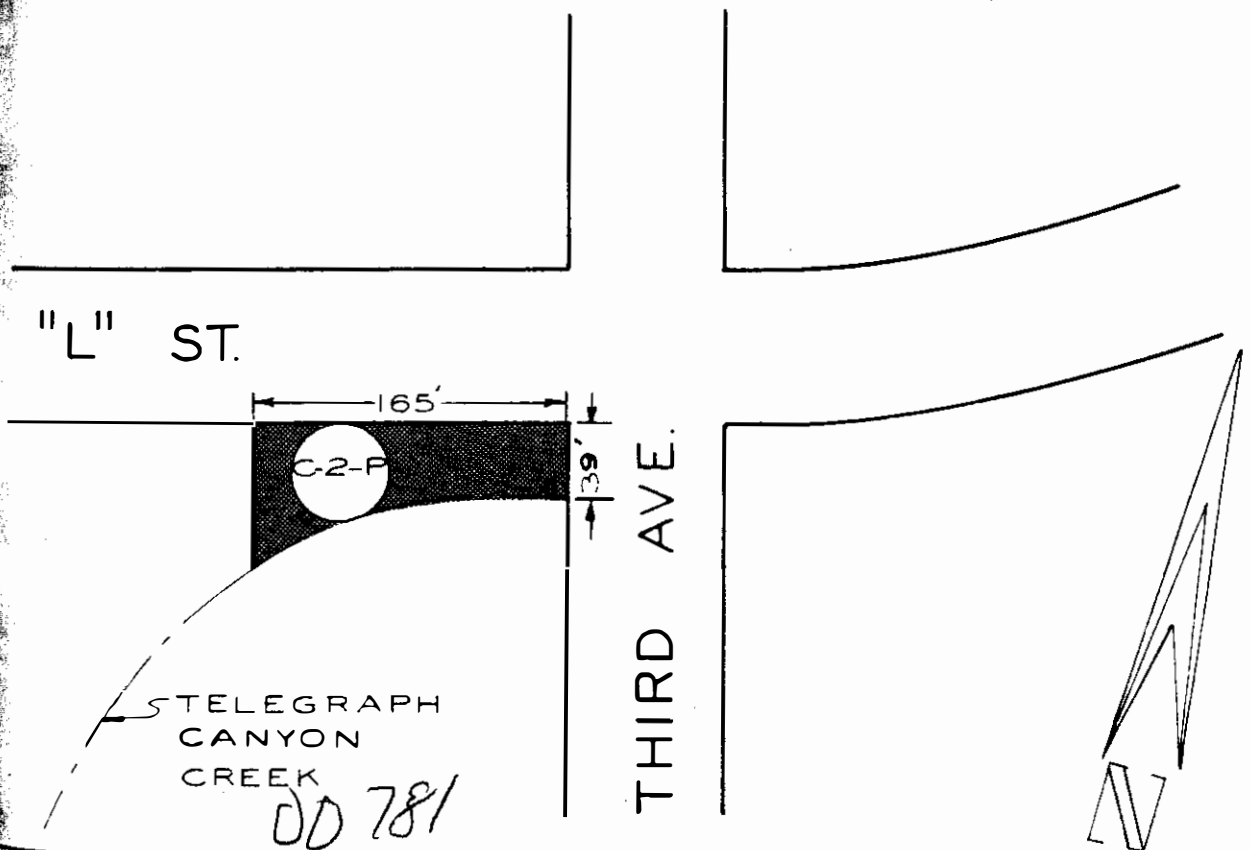

reference to which is hereby made and the same
incorporated herein as though here set forth in full,

Section 2

The Chula Vista Building Line
Map is hereby ^{Amended} modified and changed
to show a building set back ^{line of 5 feet} on the
~~South~~ ^{South} side of "L" Street west 165' feet
from the westerly line of 3rd Ave and
a building set back line of 5 feet on the
~~east~~ westerly side of 3rd Ave south 35 feet
from the ~~South~~ ^{South} side of "L" Street

00781